

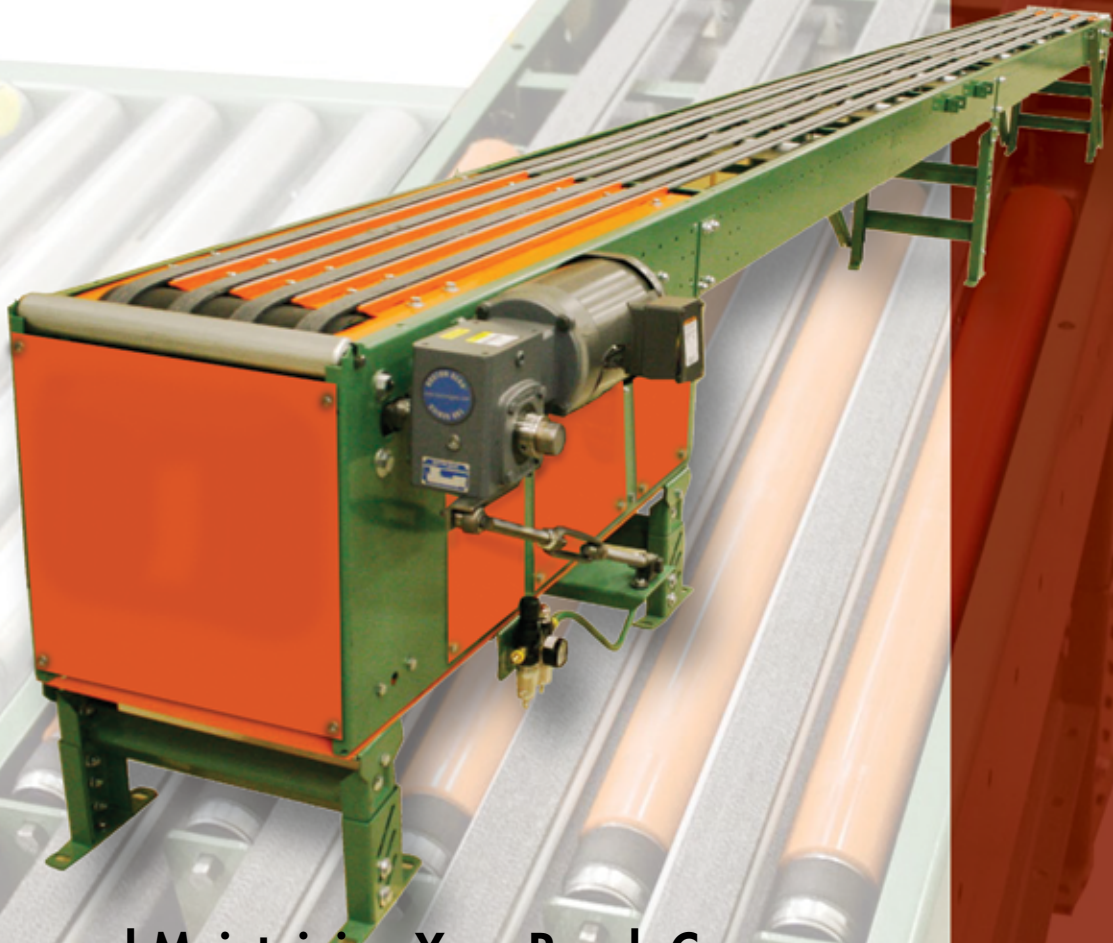

# OWNER'S MANUAL



Installing and Maintaining Your Roach Conveyor

## Narrow Belt Sorter

DO NOT OPERATE BEFORE READING THIS HANDBOOK  
KEEP IN A SAFE PLACE - DO NOT DISCARD

# MODEL NBS TABLE OF CONTENTS

<b>TECH HANDBOOK FOR NBS</b> .....	2
-Warning Labels.....	2
<b>CAUTIONS, WARNINGS AND HAZARDS</b> .....	3
-Introduction.....	3
-Cautions, Warnings and Hazards.....	3
<b>SAFETY INFORMATION</b> .....	4
-Important Safety Guidelines.....	4
<b>RECEIVING AND INSPECTION</b> .....	4
-Shortages, Damages and Return Authorizations.....	4
<b>ELECTRICAL INFORMATION</b> .....	5
-Electrical information.....	5
-Belt Path.....	5
<b>MAINTENANCE SAFETY PRECAUTIONS</b> .....	6
-Before Performing Maintenance.....	6
-Maintenance and Follow-Up Details.....	6
-Serial Plate.....	6
<b>MAINTENANCE AND LUBRICATION</b> .....	7
-Maintenance Schedules.....	7
-Report on Miscellaneous Maintenance Performed.....	7
<b>PARTS LISTS FOR NBS</b> .....	8
-Parts list.....	8
-Parts Drawing.....	9
<b>PARTS LISTS 90 DEGREE ROLLER TRANSFER</b> .....	10
-Parts list.....	10
-Parts Drawing.....	11
<b>PARTS LIST 30 DEGREE SKEWED WHEEL DIVERTER</b> .....	12
-Parts list.....	12
-Parts Drawing.....	13
<b>WARRANTY</b> .....	15

## WARNING LABELS



ABOVE: Label attached to all protective guards (drives, roller guards, etc.)



ABOVE: Label placed near all pulleys (center drives, end drives, tail pulleys)



ABOVE: Label placed near all drive assemblies and at 30' intervals

# CAUTIONS, WARNINGS AND HAZARDS

## INTRODUCTION

This manual was prepared as a “how-to-guide” for installers, end-users and maintenance personnel. It is also intended to educate both owner (purchaser) and all individuals working around the unit, of potential hazards.

With proper installation and maintenance, sorters are essential for achieving a variety of functions essential in today’s industrial marketplace. By following a simple, periodic maintenance schedule, the life of a typical sorter (or, most any type of machinery--including our automobiles!) will increase when compared to a similar unit

in an application receiving little or no maintenance. You may find that a sorter can become your best workplace friend by following simple safety guidelines. **Failure to follow even the most basic safety suggestions can result in serious personal injury.**

Sorters contain many moving: therefore, it is imperative to become familiar with basic unit operation and know all points of potential hazards.

Remember, when working around or near Sorters (and any industrial machinery)

it is **your** responsibility to become familiar with the unit, to know potential hazards (many are noted with caution labels) and to operate unit in strict accordance with the safety guidelines in this manual.

Keep this manual in a safe place for future reference. It should be placed where appropriate personnel may maintain proper maintenance and records.











**This manual must be read by all new users before operating or working near this unit.**

 **WARNING**

**DO NOT OPERATE BEFORE READING THIS MANUAL!**  
**KEEP IN SAFE PLACE--DO NOT DISCARD!**

## CAUTIONS, WARNINGS AND HAZARDS

 **WARNING**

 NEVER connect belt conveyors directly to gravity conveyors, machinery or fixtures without using connector brackets & pop out roller.	 To check drive sprocket alignment, shut “OFF” and lock out power source before attempting any adjustments.
 ALWAYS anchor permanent supports to floor (or mounting surface). Use 3/8” x 2-1/2” (or longer) wedge anchors for permanent installation in concrete flooring.	 To check drive sprocket tension, shut “OFF” and lock out power source before any adjustments are attempted.
 It is the responsibility of the customer and installation personnel to supply and install net or mesh guarding on overhead mounted conveyors to prevent product and/or debris from falling to floor in areas where required.	 Electrical controls must be designed by a qualified electrical engineer to ensure that appropriate safety features (emergency stops, pull cards, switches, etc.) are installed on unit for safe operation. Before conveyor start-up, all operators and other personnel coming in contact with unit must be properly trained and must have read accompanying Tech Handbook.
 If belt conveyor pulleys are adjusted during installation or maintenance, nip point guard (at drive end on end drive unit) must be readjusted. Nip point guard (take-up end) is automatically adjusted when take-up pulley is adjusted. Nip point guards at both ends of conveyor (center drive) must be readjusted. Center drive guards <b>MUST</b> be replaced after installation or maintenance.	 Upon start-up, if belt tracks to one side, turn unit “OFF”, lock out power source and confirm that conveyor is square and that all prime tracking components are square with bed. Belt tracking adjustments should be performed by trained personnel <b>ONLY</b> . Read section on “Belt Tracking” completely before attempting belt tracking adjustments.
 Before unit is ready for operation, snub roller guard (cover) must be adjusted to ensure safe unit operation.	 Only trained personnel shall perform maintenance functions. Before maintenance operations are performed, shut conveyor “OFF” and lock out power source to prevent unauthorized start-up. When maintenance is completed, only authorized personnel shall be permitted to start conveyor following maintenance or other emergency shut-off.
 Belt lacing must be kept in good condition for safe work environment.	

# SAFETY INFORMATION/RECEIVING AND INSPECTION

## IMPORTANT SAFETY GUIDELINES

### ! WARNING

**WARNING:** All personnel coming in contact with this conveyor should be aware of the following safety guidelines **BEFORE USING OR WORKING AROUND CONVEYOR**. **NOTE:** ALWAYS notify Roach Manufacturing® whenever any conveyor is used in an application or condition other than was originally intended. Failure to notify Roach® may allow conveyor to be operated in a hazardous operating condition. Injuries resulting from negligence or violation of safety instructions hereby removes responsibility of product liability claims from Roach®.

! Do not operate conveyor with protective guards removed. This includes chain guards, belt guards, snub roller guards, center drive guards and any other safety guard.

! Do not walk, ride, climb, or touch moving parts on a conveyor in operation.

! Do not wear loose clothing or uncovered hair around conveyor.

! Do not work near conveyor without knowing how & where to shut power "OFF" and lock out power source.

! Do not remove jammed product with conveyor running.

! Do not replace parts or perform maintenance on conveyor, or moving conveyor parts, without first shutting "OFF" power to conveyor and locking out power source.

! Do not connect gravity to powered conveyor without safety gravity connector brackets.

! To prevent electrical shock, conveyor must be grounded, and have proper electrical connections in accordance with federal, state, and local codes.

! Safety pop out rollers in conveyors installed above 7'-0" elevation must be retained by guard rail, clips, etc. Safety

pop out rollers must be allowed to pop out when conveyors are installed at or below 7'-0" elevation.

! It is the responsibility of conveyor end-user to comply with all safety standards including OSHA and other federal, state, and local codes or regulations. Install protective guarding and other related safety precautionary equipment to eliminate hazardous operating conditions which may exist when two or more vendors supply machinery for related use.

! Any violation of above safety instructions hereby removes all product liability claims from Roach Manufacturing Corporation®.

## SHORTAGES, DAMAGES AND RETURN AUTHORIZATIONS

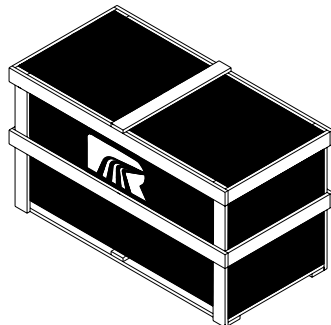

Before uncrating, check quantity of items received against bill of lading to confirm that all material has been received. Examine the condition of the equipment to determine if any damage has occurred.

Also, it is possible that some items may become separated from the original shipment. Therefore, when receiving goods, it is imperative that the bill of lading (or,

accompanying freight documentation) be checked to ensure receipt of ALL units ordered including ALL accessories.

Damage and/or shortage in shipment should be reported immediately to both vendor and carrier. Obtain a signed damage report from carrier agent and send copy to vendor. **Do not repair any damage before obtaining this**

**NOTE:** Do not return goods to factory without prior, written return authorization. Unauthorized returns are subject to refusal at factory.

### report.

For damaged shipments, consult factory to determine if entire shipment must be returned to factory for repair **or** if an immediate order should enter production to produce a new, replacement shipment.

# MODEL NBS ELECTRICAL OPERATION

---

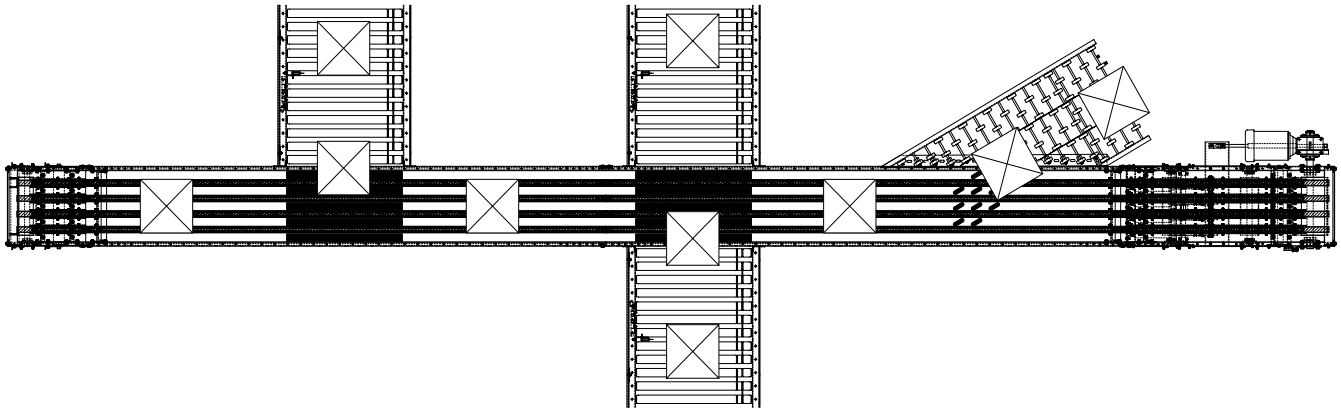

The Diverters are controlled with a single solenoid valve provided on the unit. This is the only electrical control supplied with the diverter. The valve is to be energized to make the product divert. When the valve is de-energized the diverter will return to its normal position. A delay may be required to keep the diverter energized until the product clears the main line conveyor.

The customer should supply the controls (encoders, photoeyes, etc) necessary to track the package throughout the system and make the decision to divert when the package has arrived at the diverter. A photoeye should be placed at the diverter to confirm that the product has arrived.

# MODEL NBS BELT PATH

---

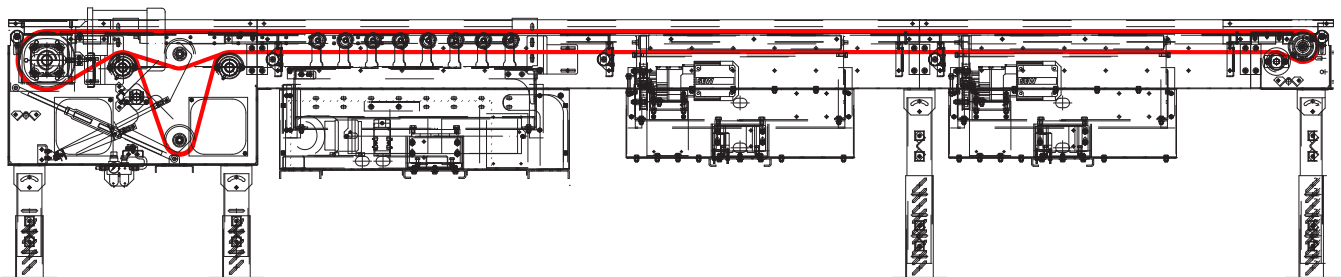

# MAINTENANCE SAFETY PRECAUTIONS BEFORE PERFORMING MAINTENANCE

**CAUTION:** Only trained personnel shall perform maintenance functions. Before maintenance operations are performed, the NBS must be shut "OFF" and disconnects locked in the "OFF" position to prevent unit from unauthorized start-up.

One of the most important guidelines for maximizing sorter operation and personnel safety is to implement a regular maintenance schedule and train personnel on the appropriate needs of the specific unit.

Only trained personnel shall perform maintenance functions. Before maintenance operations are performed, sorter must be shut "OFF" and disconnects locked in the "OFF" position to prevent unit from unauthorized start-up during maintenance. Make sure air

flow to unit is turned "OFF". All personnel should be informed of the safety procedures associated with unit maintenance and performance.

Do not perform any work on sorters or sorter system while in operation unless it is impossible to otherwise conduct adjustment, lubrication or other maintenance function. Only experienced, trained personnel possessing advanced hazards-training should attempt such critical operations.

# MAINTENANCE SAFETY PRECAUTIONS MAINTENANCE AND FOLLOW-UP DETAILS

**CAUTION:** Only trained personnel shall perform maintenance functions. When maintenance is completed, only authorized personnel shall be permitted to start diverter following maintenance or other emergency shut-off.

While performing maintenance do not wear loose clothing. Immediately report any hazardous conditions--sharp edges, pinch (or nip) points or other conditions that may result when several manufacturers supply machinery which may create operating hazards.

When using mechanical aids such as hoists, cables, or cranes exercise extreme caution to prevent damage to diverters or other integrated machinery which may create a working hazard when maintenance is completed and units are in operation.

Clean up any spilled lubricants or other materials used in the maintenance process or those which may be deposited during unit operation. Eliminating poor housekeeping practices increases unit efficiency while creating safer personnel working conditions.

After maintenance, conduct visual inspection to ensure that all safety devices and guards have been replaced. Confirm that all units are clear of tools, debris or other items. Before starting conveyor, check condition of unit caution labels (see "WARNING LABELS" at front of handbook). If labels have been destroyed or are not clearly legible, call 870.483.7631 to receive replacement labels. Placement of warning labels is critical to avoid unauthorized unit operation which may result in hazardous working conditions for all related personnel coming in contact with diverter.

Warn personnel that the NBS is being prepared for start-up and to stay clear of unit. Do not start diverter until all personnel are clear. When maintenance is completed, only authorized personnel shall be permitted to start diverter following maintenance or other

# REPLACEMENT PARTS SERIAL PLATE

To order any replacement parts or when calling for assistance with any powered conveyor, **ALWAYS** provide the unit serial number. This aluminum plate is placed on the NBS frame.

To order replacement parts or add-on components, contact the Roach distributor who originally furnished the unit if possible. If this is not possible, contact the National Sales Office at 870-483-7631 for the name of the authorized Roach distributor in your area. Have unit model number and serial number **BEFORE** calling. Refer to unit drawings (in rear section of

handbook) for part numbers if ordering replacement parts.

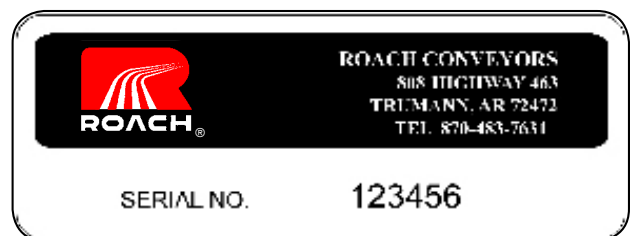



# MODEL NBS PARTS LIST

ITEM #	DESCRIPTION
1	1 4" FIXED END ASSEMBLY
2	4 BEARING SPACER (FOR 2 HOLE)
3	2 2.5 RETURN ROLLER BRACKET
4	1 FRAME CROSSBRACE
5	1 196G ROLLER ASSY 1 7/16"HEX SHAFT THREADED
	2 1/2"-20 NYLON INSERT JAM NUT
6	2 SPLICE PLATE (FOR FRAME)
7	1 END GUARD 9 11/16"LG. L.H.
8	1 END GUARD 9 11/16"LG. R.H.
9	5 CENTER GUARD 6 3/32"LG.
10	6 ALUM. GUIDE RAIL 6 3/8"LG
11	6 UHMW PROFILE 6 3/8"LG.
12	1 4" IDLER PULLEY (TAPPED SHAFT)
13	1 251G SNUB GUIDE ROLLER
14	2 POP-OUT ROLLER PLATE
15	1 4" FIXED END PLATE LH
16	4" FIXED END PLATE RH
17	1 FIXED END GUARD
18	1 CROSSBRACE WELD ASSY
19	26 1/4"-20 X 3/4"LG. HHCS
20	2 5/16" S.S. FLAT WASHER
21	6 10-24 X 1" F.H.S.M.S.
22	14 1/4"-20 CAGE NUT
23	12 1/4"-20 NYLON INSERT LOCK NUT
24	14 1/4" FLAT WASHER
25	14 1/4" LOCK WASHER
26	2 5/16" X 1/4" X 1/4"-20 S.H.S.S
27	6 10-24 FLANGE NUT
28	2 1/4"-20 FLANGE NUT
29	2 2 HOLE FLG.BRG. W/ 1 3/16"BORE
30	ENCODER
31	1 4' INTERMEDIATE BED SECTION ASSY
32	1 196G ROLLER ASSY 23 1/2" BF 6 2 SPLICE PLATE (FOR FRAME)
33	2 RETURN ROLLER BRACKET
34	24 BELT GUIDE (FOR CROSSBRACE)
35	2 CROSSBRACE WELD ASSY
36	2 SIDE CHANNEL
37	2 SIDE CHANNEL
38	6 UHMW PROFILE
39	6 BOTTOM SUPPORT TUBE 19 4 1/4"-20 X 3/4"LG. HHCS
40	12 1/4"-20 X 1 3/4"LG. HHCS 23 12 1/4"-20 NYLON INSERT LOCK NUT 27 6 10-24 FLANGE NUT 28 4 1/4"-20 FLANGE NUT
41	6 10-24 X 1 3/4"LG. FHMS
42	INTERMEDIATE BED SECTION ASSY.
43	2 SIDE CHANNEL
44	6 UHMW PROFILE
45	6 ALUM. GUIDE RAIL
46	6 BOTTOM SUPPORT TUBE
47	1 8" END DRIVE ASSEMBLY
48	1 BEARING TAKE-UP MOUNTING ANGLE
49	1 BEARING PUSH PLATE
50	1 1/4" FRL MOUNTING ANGLE
51	6 MODIFIED PULLEY IDLER
52	2 SHAFT MOUNT WELD ASSY

ITEM #	DESCRIPTION
53	1 SHAFT MOUNTING BLOCK
54	1 DRIVE END GUARD
55	1 DRIVE END GUARD
56	5 DRIVE CENTER GUARD
57	6 PIVOT PLATE WELD ASSEMBLY
58	6 ALUM. GUIDE RAIL
59	6 UHMW PROFILE
60	1 PIVOT SHAFT
61	1 FRAME CROSSBRACE
62	1 8" DRIVE PULLEY
63	2 4" IDLER PULLEY (DRIVE END)
64	1 PLUMBING CHANNEL WELD ASSY 14 2 POP-OUT ROLLER PLATE
65	1 8" END DRIVE PLATE LH 1 8" END DRIVE PLATE RH
66	1 8" END DRIVE PLATE 36"LG. RH
67	1 DRIVE END GUARD
68	1 DRIVE BOTTOM GUARD
69	4 SMALL COVER PLATE
70	1 CYLINDER MNTG CHAN WELD ASSEMBLY
71	1 ANGLE GUARD 1 PULLEY SHAFT COVER
72	8 1/4"-20 X 3/4"LG. WHIZ LOCK SCREW 19 24 1/4"-20 X 3/4"LG. HHCS 20 2 5/16" S.S. FLAT WASHER
73	1 3/8"-16 X 3"LG. HHTB
74	8 5/16"-24 X 1"LG. SHCS W/PATCH LOCK
75	6 5/16"-18 X 3/4"LG. CARRIAGE BOLT
76	2 #14 X 3/4"LG. HEX HEAD SLT 21 6 10-24 X 1" F.H.S.M.S. 22 22 1/4"-20 CAGE NUT 23 12 1/4"-20 NYLON INSERT LOCK NUT 24 14 1/4" FLAT WASHER 25 14 1/4" LOCK WASHER
77	6 5/16"-18 FLANGE HEX NUT 26 2 5/16" X 1/4" X 1/4"-20 S.H.S.S. 27 6 10-24 FLANGE NUT
78	6 5/8"-11 NYLON INSERT JAM NU 28 24 1/4"-20 FLANGE NUT
79	6 5/8" FLAT WASHER
80	6 3/4"-16 NYLON INSERT THIN JAM NUT
81	6 SHOULDER STUD
82	2 1" ID TOP HALF COUPLING
83	2 1" ID TOP HALF COUPLING
29	4 2 HOLE FLG.BRG. W/ 1 3/16"BORE
84	2 4 HOLE FLG.BRG. W/ 1 7/16"BORE
85	6 PARKER ROD CLEVIS
86	6 PARKER PIVOT BRACKET
87	6 PARKER SR CYLINDER 1.5"BR 6"STROKE
88	1 2HP/230/460/3/145TC TEBC MOTOR
89	1 CHF721-10-Z-B7-P23 BOSTON HOLLOW BORE REDUCER
90	PLUMBING ASSY
91	1 CHANNEL CROSSMEMBER
92	1 REACTION ROD KIT
93	2 90° ROLLER DIVERTER ASSEMBLY
94	1 30° SKEWED WHEEL DIVERTER ASSEMBLY
95	6 1.25" WIDE BELT
96-97	SUPPORT
98-102	SOLID GUARD



# MODEL NBS ASSEMBLY DRAWINGS

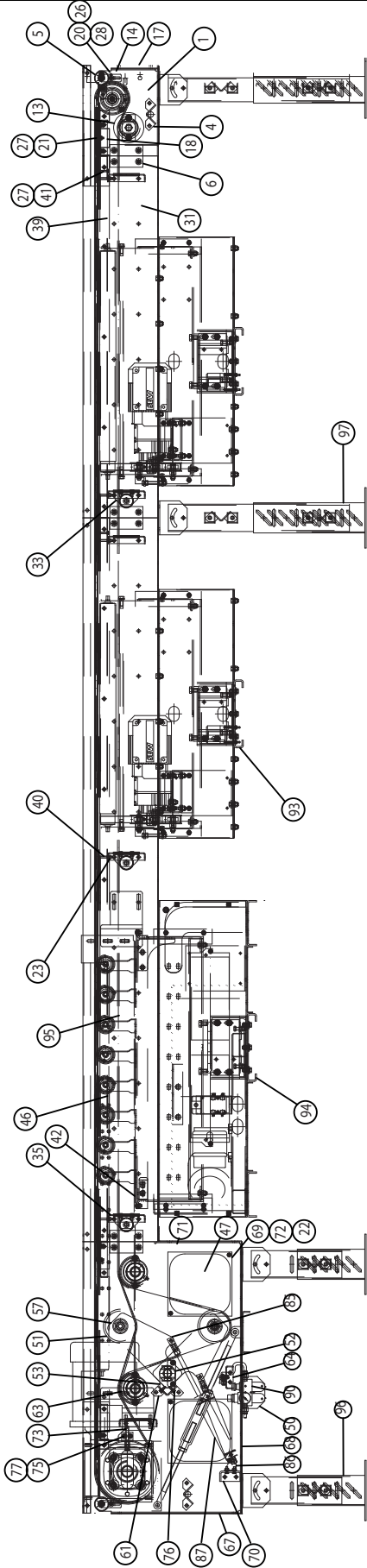
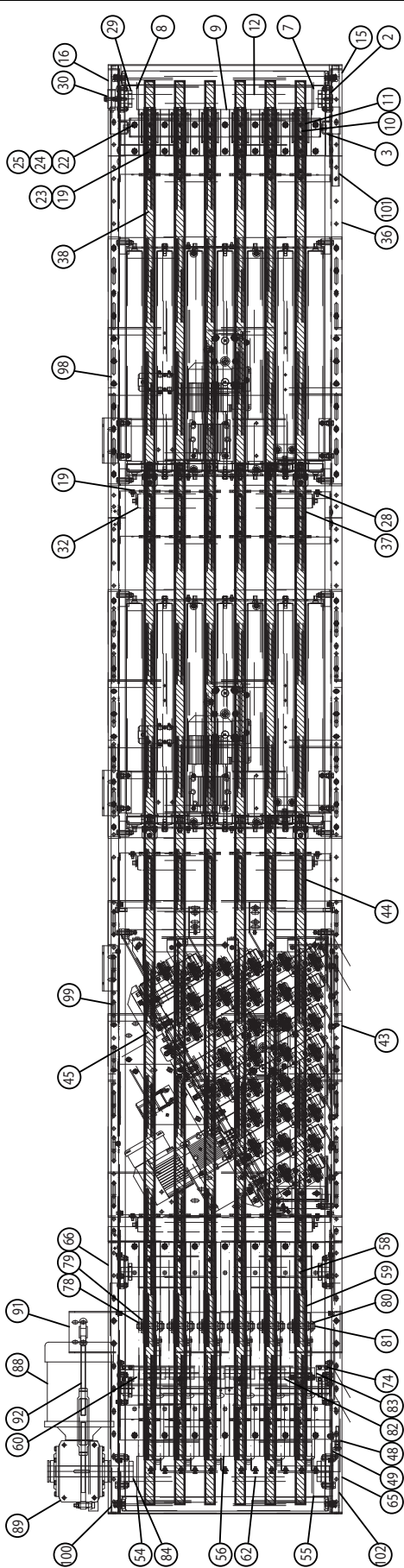

# MODEL NBS PARTS LIST

ITEM #	DESCRIPTION
1	3 BED SPACER ROD
2	1 SHEAVE MOUNTING ANGLE
3	1 DRIVE SHEAVE 3/4" BORE
4	1 DRIVE SHEAVE 3/4" BORE
5	1 DIVERTER ROLLER MOUNTING ANGLE L.H.
6	1 DIVERTER ROLLER MOUNTING ANGLE R.H.
7	1 DIVERTER LIFT CHANNEL
8	1 MOTORBASE CHANNEL
9	4 MOTORBASE MOUNTING ANGLE
10	4 SHEAVE TAKE-UP ANGLE
11	1 CYLINDER BASE CHANNEL
12	2 ACCESS COVER GUARD
13	1 CYLINDER MOUNT WELD ASSY
14	1 CYLINDER ADJUSTMENT ANGLE WED ASSY
15	2 GUIDE BLOCK
16	2 GUIDE BLOCK
17	7 196G COVERED ROLLER
18	2 GUARD END COVER
19	4 5/16"-18 X 1"LG. HHCS
20	8 3/8"-16 X 3/4" HHC
21	38 3/8"-16 X 1" HHCS
22	19 3/8"-16 X 2" HHCS
23	2 3/8"-16 X 3" HHTB
24	6 7/16"-14 X 1" HHCS
25	4 1/2"-13 X 3/4" HHCS
26	4 1/2"-13 X 1"LG. HHCS

ITEM #	DESCRIPTION
27	4 1/4"-20 X 3/4"LG. CARRIAGE BOLT
28	4 5/16"-18 X 3/4"LG. CARRIAGE BOLT
29	2 3/8"-16 X 2"LG. CARRIAGE BOLT
30	2 10-24 X 2"LG, RHSMC
31	4 1/4"-20 HEX FLANGE NUT
32	8 5/16"-18 HEX FLANGE NUT
33	8 3/8"-16 HEX NUT
34	2 10-24 HEX FLANGE NUT
35	59 3/8"-16 FLG.NYLON INSERT LOCK NUT
36	20 3/8" FLAT WASHER
37	6 3/8" LOCK WASHER
38	2 3/8"-16 NYLON INSERT JAM NUT
39	6 7/16" LOCK WASHER
40	4 1/2" LOCK WASHER
41	4 1/2"ID INTERNAL TOOTH STAR WASHER
42	5 3/8"NPT X 3/8" STRAIGHT CONNECTOR
43	1 3/8" C-38 SPEED CONTROL MUFFLER
44	3FT 3/8" O.D. X 1/4" I.D. BLACK TUBING
45	1 7/8"WIDE TC-20EF X 142"LG 2MM BELT
46	2 10-24 X 1/4"LG. SCKT HEAD SET SREW
47	1 MAC 6311D-211-PM-591DA-3/8"PORTS 24 VOLT SINGLE SOLENOID VALVE
48	1 PB252 SK10 CB TOLOMATIC CYL.1"STRK.
49	1 EURODRIVE R17DRS71 S2/LN FOOT MOUNT
50	FLAT IDLER (FIP2000-1.02-SA08)
51	2 3/8"-16 X 1 1/2" HHCS
52	1 3/8" INLINE FLOW CONTROL VALVE

# MODEL NBS 90 DEGREE ROLLER TRANSFER

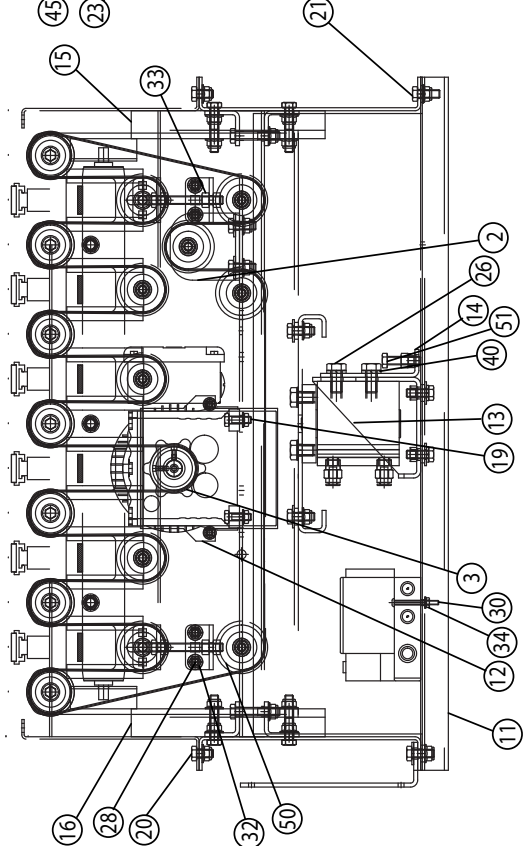
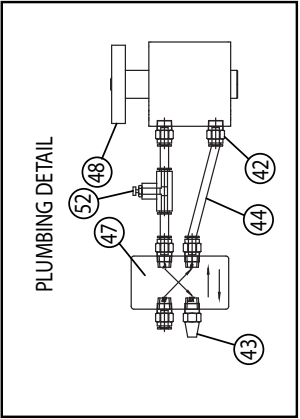
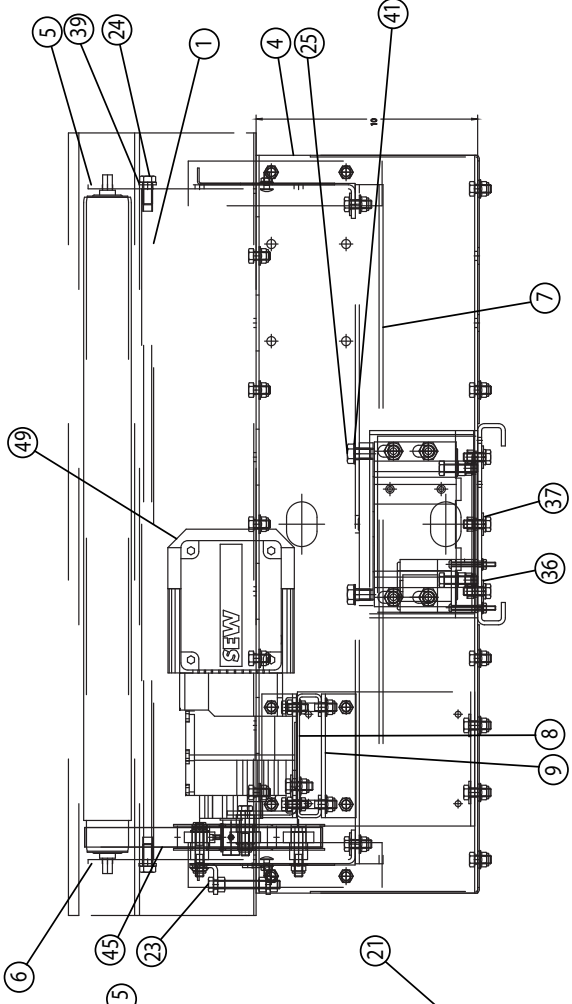
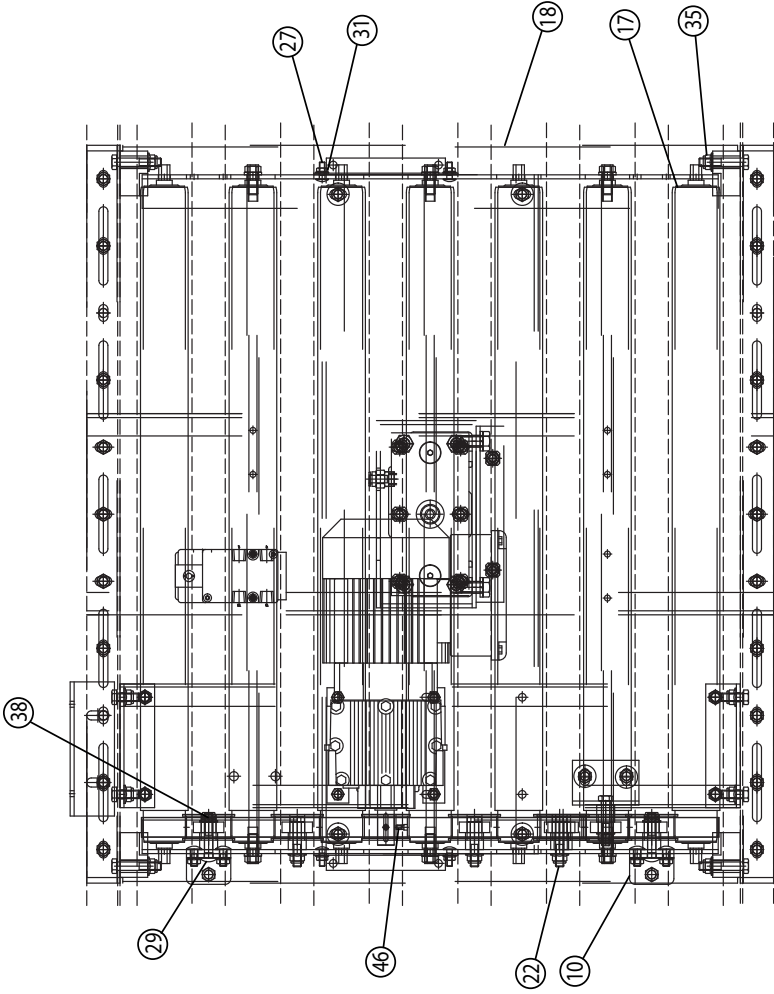

# MODEL NBS PARTS LIST

ITEM #	DESCRIPTION
1	196G GROOVED ROLLER
2	196G GROOVED ROLLER
3	196G GROOVED ROLLER
4	32 WHEEL SUB ASSEMBLY
5	DRIVE SHEAVE 3/4"BORE
6	4 SHEAVE TAKE-UP ANGLE
7	1 CYLINDER MOUNT WELD ASSY
8	1 CYLINDER ADJ. ANG. WELD ASSY
9	1 DIVERTER DRIVE SIDE PLATE LH
10	1 DIVERTER DRIVE SIDE PLATE RH
11	1 CENTER DIVERTER SIDE PLATE LH
12	1 CYLINDER BASE CHANNEL
13	1 CHANNEL CROSSMEMBER (INFEED)
14	1 CHANNEL CROSSMEMBER (DISCHRG)
15	1 DIVERTER LIFT CHANNEL L.H.
16	1 MOTORBASE CHANNEL
17	8 30° BOLT-ON ROLLER CLIP
18	2 30° ROLLER SUPPORT ANGLE L.H.
19	1 VALVE MOUNTING ANGLE
20	32 WHEEL MOUNTING ANGLE
21	1 ROLLER RETAINER STRAP
22	1 SUPPORT ANGLE (CTR.CHAN) L.H.
23	1 PLATE SUPPORT ANG (LARGE)L.H.
24	1 PLATE SUPPORT ANGLE (SMALL)
25	2 ANGLE STIFFENER (LIFT CHAN)
26	1 WHEEL MOUNTING CHANNEL L.H.
27	2 ANGLE STIFFENER
28	1 ANGLE STIFFENER
29	1 ANGLE STIFFENER
30	1 ANGLE STIFFENER
31	5 STIFFENER CHANNEL MOUNT L.H.
32	1 CONNECTOR STRAP
33	1 GUARD BOTTOM COVER
34	1 GUARD BOTTOM COVER
35	2 GUARD END COVER
36	2 GUARD END COVER
37	1 GUIDE BLOCK L.H.
38	1 GUIDE BLOCK R.H.
39	1 CORNER GUIDE BLOCK L.H
47	1 196G GROOVED ROLLER
48	1 196G GROOVED ROLLER
49	1 BED SPACER ROD
50	1 BED SPACER ROD
51	1 BED SPACER ROD
52	13 1/4"-20 X 3/4"LG
53	4 5/16"-18 X 3/4"LG HHCS
54	22 3/8"-16 X 3/4"LG HHCS

ITEM #	DESCRIPTION
55	73 3/8"-16 X 1"LG HHCS
56	34 3/8"-16 X 1 1/2"LG HHCS
57	16 3/8"-16 X 2"LG HHCS
58	2 3/8"-16 X 3"LG HHTB
59	6 7/16"-14 X 1"LG. HHCS
60	4 1/2"-13 X 3/4"LG HHCS
61	4 1/2"-13 X 1"LG HHCS
62	4 1/4"-20 X 1/2"LG CARR. BOLT
63	27 5/16"-18 X 3/4"LG CARR. BOLT
64	87 3/8"-16 X 3/4"LG CARR. BOLT
65	2 3/8"-16 X 2"LG CARRIAGE BOLT
66	2 10-24 X 2"LG RHSMS
67	13 1/4"-20 CAGE NUT
68	4 1/4"-20 HEX FLANGE NUT
69	31 5/16"-18 FLANGE NUT
70	8 3/8"-16 HEX NUT
71	2 10-24 FLANGE HEX NUT
72	226 3/8"-16 SMOOTH FLG.NYLN INSRT
73	55 3/8" NOM. FLAT WASHER
74	6 3/8" LOCK WASHER
75	6 7/16" LOCK WASHER
76	Underneath Motorbase Plate
77	Center Drive Chain Guard Assembly
71	2 10-24 FLANGE HEX NUT
72	226 3/8"-16 SMOOTH FLG.NYLN INSRT
73	55 3/8" NOM. FLAT WASHER
74	6 3/8" LOCK WASHER
75	6 7/16" LOCK WASHER
76	Underneath Motorbase Plate
77	Center Drive Chain Guard Assembly
76	4 1/2" LOCK WASHER
77	4 1/2"ID INTERNAL TOOTH LCKSTAR
78	5 3/8"NPT X 3/8" STRAIGHT CONN
79	1 C-38 SPEED CONTROL MUFFLER
80	3' 3/8"OD X 1/4"ID BLACK TUBING
81	1 7/8"W TC-20EF 149"LG 2MM BELT
82	2 10-24 X 1/4" S.H. SET SCREW
83	1 EURODRIVE R17DRS71S2/LN FOOT 443 OUTPUT RPM
84	MAC 6311D-211-PM-591DA-3/8" PORTS 24V SGL SOLENOID VALVE
85	1 PB252 SK10 CB TMATC CYL.1"STR
86	10 FPI2000-1.02-SA08 FLAT IDLER
87	32 3/16"DIA X 22.5"LG HT85A BAND
88	1 CYLINDER RESTRICTOR BLOCK
89	8" DOUBLE SIDED TAPE 0.03THK.
90	1 3/8" INLINE FLOW CONTROL VLV.

# MODEL NBS 30 DEGREE SKEWED WHEEL DIVERTER

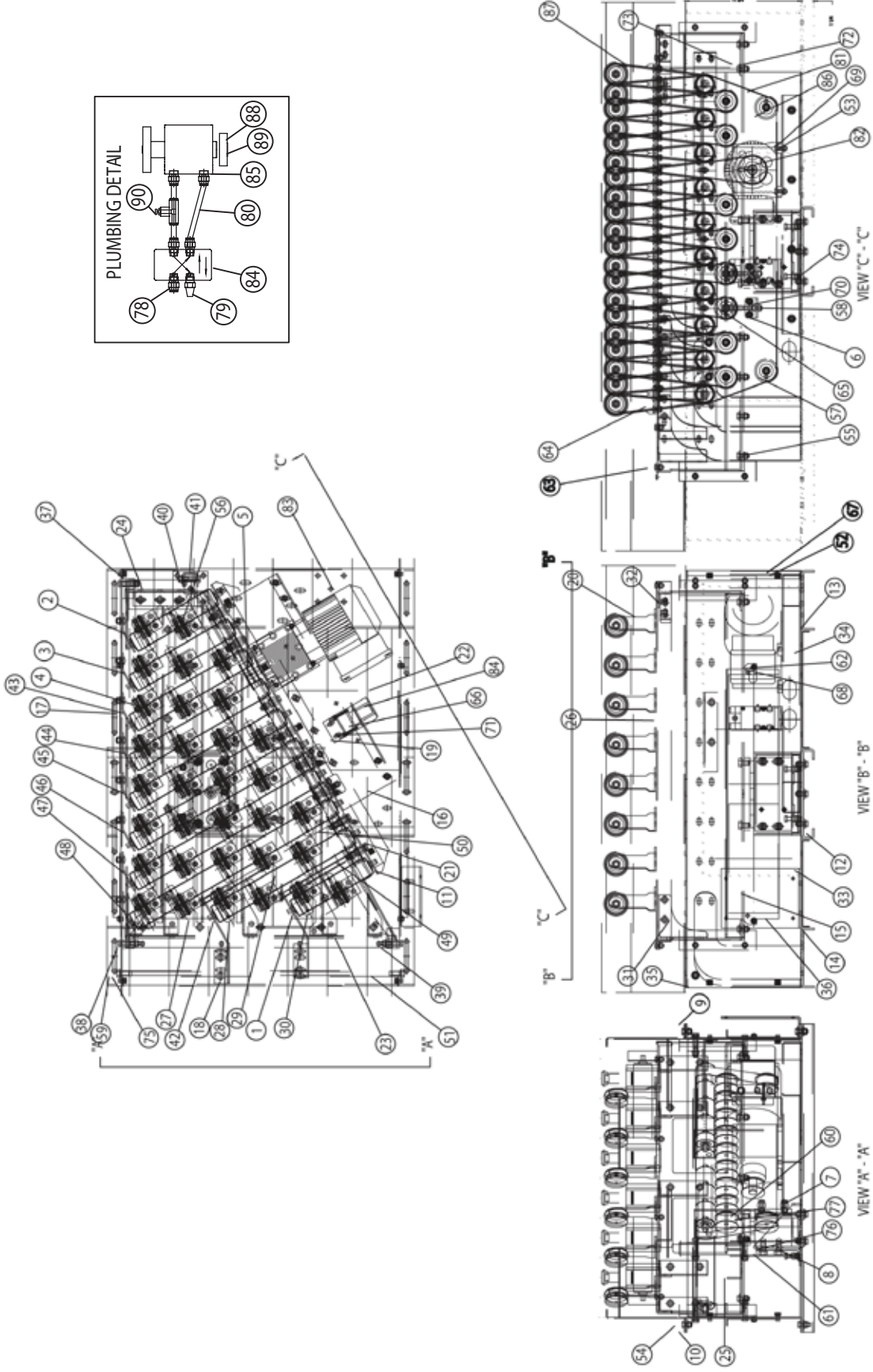





# ROACH CONVEYORS

## WARRANTY

- Materials used by Roach Conveyors are of good quality.
- Any part proving to be defective in materials or workmanship upon Roach inspection, will be replaced at NO cost, FOB, Trumann, Arkansas, for one year. Installation expense will be paid by others.
- Roach liability includes furnishing said part or parts; Roach is not liable for consequential damages, such as loss of profit, delays or expenses incurred by failure of said part or parts.
- Failure due to abuse, incorrect adjustments, exposure to corrosive or abrasive environment or operation under damp conditions does not constitute failure due to defects in workmanship or materials.
- Component parts not manufactured by Roach (motors, gear reducers, etc.) will be repaired or replaced at the option of their manufacturer. Contact nearest authorized service center for all warranty claims.

NOTE: Motors or gear reducers tampered with before inspection shall be considered free of ALL Warranty Claims.

--All specifications are subject to change without notice--  
--Drawings are intended for illustration ONLY and are not to scale--



808 HIGHWAY 463  
TRUMANN, ARKANSAS 72472-1310  
Tel 870-483-7631 Fax 870-483-7049  
info@roachconveyors.com  
www.roachconveyors.com